

METAL DETECTABLE BELT SCRAPERS 5.2011

MT-1-MD SCRAPERS are manufactured from a premium compound of abrasion resistant FDA approved TPU resins. This plastic material has been specially selected for stability and toughness. The flexing action of the MAXI-TIP -1 provides positive cleaning and plowing performance, allowing belt lacing, and joints to pass under the scraper tip. This substantially increases both belt and lace life! This unit is recommended for trough angles, V-plows and "arc" mounts.

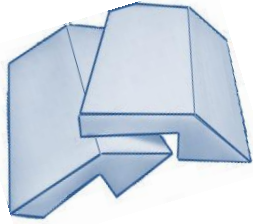

Part # MT-1-MD - 8 ft. section

MTDD-MD SCRAPERS have a co-extruded rigid base for mounting, and a soft flexible tip all in one piece. The larger base allows for direct mounting to cross supports and frames, where a blade holder cannot be installed. Suitable for use in most USDA/FDA applications.

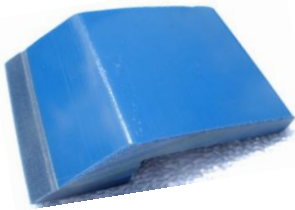

Part # MTDD- MD - 8 ft. section

MT-2-MD is manufactured from abrasion resistant MAGNETHANE PE (UHMW), and is used when applications require rigidity and stiffness for removing and redirecting foodstuff materials from belting, rollers and production equipment. MT-2-MD is constructed to produce the same magnetic signature as other MAGNETHANE™ products. This scraper is excellent for pulley cleaning, heavy product plowing and general applications. This product can be installed in the MTBH



Part # MT-2-MD - 8 ft. section

MTBH BLADE HOLDER is a 6005-T6 Clear Anodized Aluminum Extrusion, which keeps scrapers properly oriented to the work area. It maintains constant, even pressure over the blade's entire length. MTBH Blade Holder helps keep your conveyor clean, neat and sanitary.

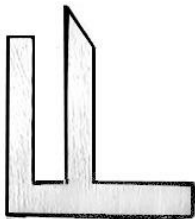

Part # MT-BH - 8 ft. section

SANISCRAPER is manufactured in a unique extrusion process which creates a smooth flowing shape. These scrapers are made from MAGNETHANE PE, and have antimicrobial silver additives for further food safety. These scrapers snap on a 3/4" keyed shaft for fast, convenient installation & removal.

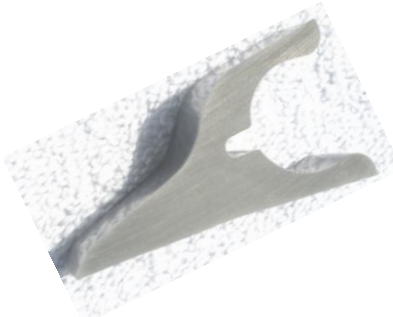

Part # MT-SS - 5 ft. & 10 ft. sections